

# ANIMATED SCARECROW™

## Installation and Operating Instructions

Keep all plastic and wire parts away from children.

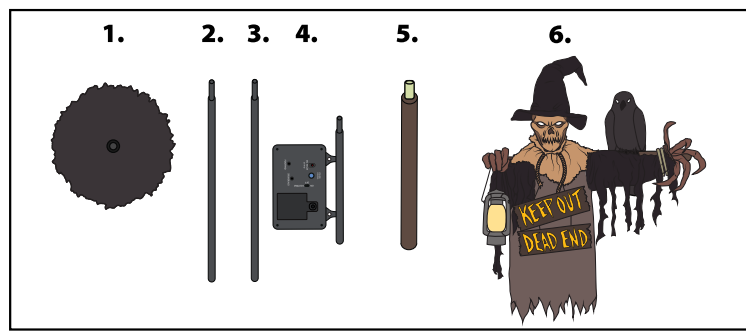

### PARTS

1. METAL BASE WITH FABRIC COVER
2. LOWER FRAME POLE
3. CENTER FRAME POLE
4. UPPER FRAME POLE AND MODULE
5. RIGHT FRAME POLE
6. SCARECROW BODY LANTERN AND CROW

1. Snap lock LOWER FRAME POLE onto the METAL BASE WITH FABRIC COVER. (Match A to A)
2. Snap lock CENTER FRAME POLE onto the LOWER FRAME POLE. (Match B to B)
3. Snap lock UPPER FRAME POLE AND MODULE onto the CENTER FRAME POLE. (Match C to C)
4. Insert the UPPER FRAME POLE AND MODULE to the snap lock located inside the clothing of the SCARECROW BODY AND LANTERN. (Match D to D)
5. Snap lock the RIGHT FRAME POLE to the pole located under the collar on the back side of the SCARECROW BODY AND LANTERN. (Match E to E)
6. Snap lock the left arm pole with CROW into the body of the SCARECROW. (Match F to F)
7. Reach under the fabric of the SCARECROW BODY and snap lock the left arm into the shoulder of the SCARECROW BODY AND LANTERN. (Match G to G)
8. Reach inside the fabric of the SCARECROW LANTERN AND BODY and connect the wires labeled H, I, J and K from the MODULE to the wires running below the head. (Connect H to H) (Connect I to I) (Connect J to J) and (Connect K to K)
9. Reach inside fabric of the SCARECROW LANTERN AND BODY and connect 6V 2A ADAPTER (not included) or insert 4 AA alkaline batteries (not included) into the battery compartment located on the MODULE. Turn the switch to ON position move in front of the item or make a loud sound (clap) to activate item. Turn the switch to the OFF position when not in use.
10. Position the item as seen in the illustration and continue to footpad or speaker set up as needed.

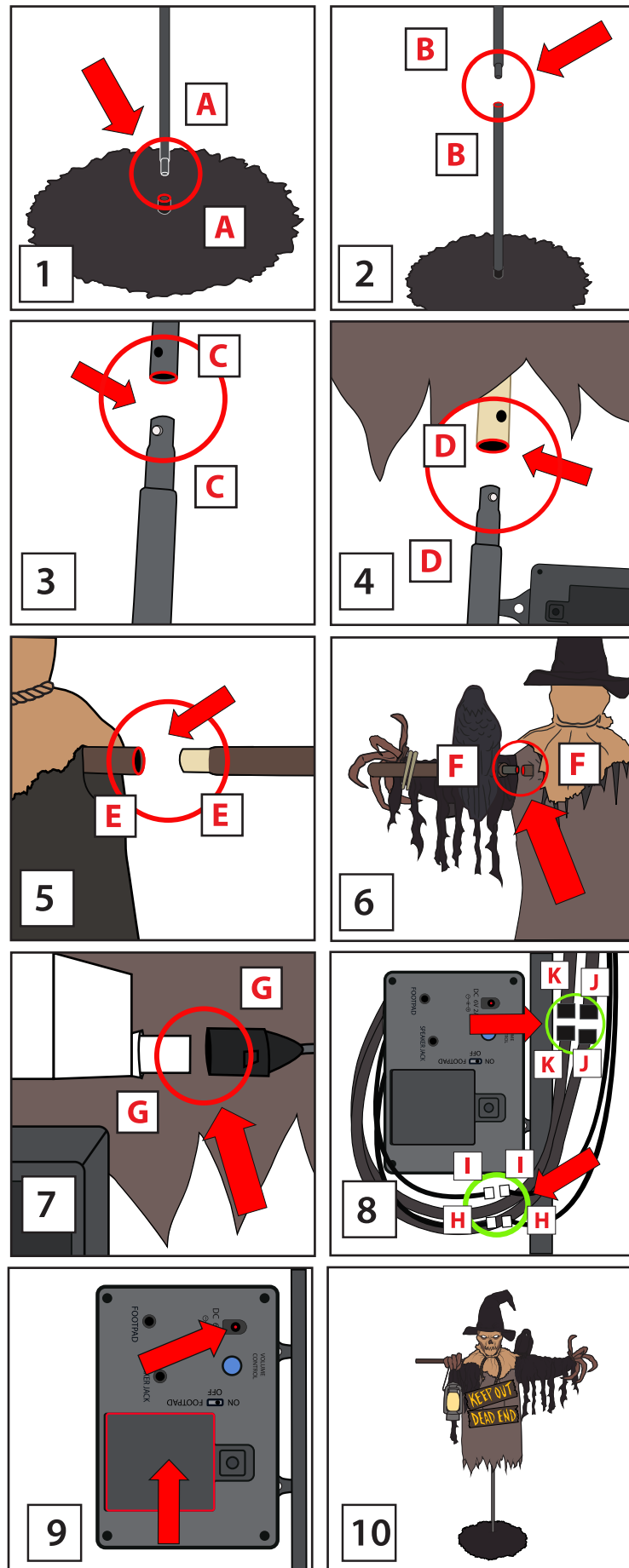

#### OPTIONAL FOOTPAD SET UP

FOOTPAD IS NOT INCLUDED. MUST BE PURCHASED SEPARATELY.

1. Insert the cable from optional footpad into the jack labeled FOOTPAD on the MODULE.
2. Place the switch in the FOOTPAD position to enable FOOTPAD activation.
3. Step on the FOOTPAD to activate the scary sequence!

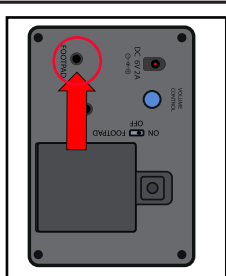

#### OPTIONAL EXTERNAL SPEAKER SET UP

EXTERNAL SPEAKER IS NOT INCLUDED. MUST BE PURCHASED SEPARATELY.

1. Plug speaker cord into the jack labeled SPEAKER JACK located on the MODULE.
2. Use volume knob on external speaker to control volume levels.

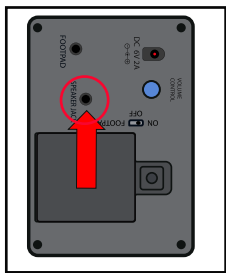

\* Footpads and adapters are sold separately and can be purchased at [www.tekkyaccessories.com](http://www.tekkyaccessories.com)

#### SMART PHONE SCAN



#### BATTERY INSTRUCTIONS AND CAUTIONS

Battery installation and removal should be performed by an adult. Remove batteries when not in use. Use only batteries recommended in the instructions. Do not mix new and used batteries. Do not mix alkaline, carbon-zinc, nickel-cadmium, rechargeable or different types of batteries. Be mindful to insert batteries with the correct polarity (+/-) as indicated. Remove all exhausted batteries. Rechargeable batteries are only to be charged under adult supervision. Rechargeable batteries are to be removed from the item before being charged. Non-rechargeable batteries are not to be recharged. The supply terminals are not to be short-circuited. Always dispose of exhausted batteries properly. Do NOT dispose of batteries in fire, they may leak or explode.

**Warning! This item is not a toy. For decoration only. Small parts, choking hazard. This product is intended for use by persons 15 years of age and older. Not intended for use by children ages 14 years and younger.**

**WARNING**  
**DO NOT TURN ITEM ON UNTIL YOU HAVE COMPLETELY FINISHED ASSEMBLY.**  
**STAY CLEAR OF ITEM WHILE OPERATING.**  
**DO NOT PLACE ITEM ON UNEVEN GROUND.**  
**DO NOT PLACE WEIGHT ON ITEM WHILE IN OPERATION.**



**DO NOT RETURN THIS ITEM TO THE STORE!**  
 If experiencing technical difficulties, please go to [www.tekkydesign.com](http://www.tekkydesign.com) for assistance.



visit us at [tekkydesign.com](http://tekkydesign.com)  
 Requires 6V 2A ADAPTER (included) or 4AA batteries (not included)

ALL NEW MATERIALS:  
 METAL, FOAM, PLASTIC, FABRIC  
 Surface washable only.

ANIMATED SCARECROW™ is a trademark of Tekky. Copyright © 2021 Tekky. All Rights Reserved. MADE IN CHINA

